

RAJAMAHENDRI

INSTITUTE OF ENGINEERING & TECHNOLOGY

AISHE ID:C-18113

NAAC DWV

CYCLE II



5 : STUDENT SUPPORT & PROGRESSION

5.2 Student Progression

5.2.2 % of Students Qualifying in State / National / International Level Exams During last 5 years

5.2.2(1) List of Students with e-copies of Qualifying Certificates in A.Y 2022-23



Approved by AICTE, New Delhi, Government of AP & Affiliated to JNTUK, Kakinada, Accredited by NAAC and An ISO 9001:2015 Certified Institution

Bhoopalapatnam, Rajamahendravararam, E.G. Dist, AP-533103

 9121214413

 www.rietrjy.co.in

 office@rietrjy.co.in

5.2.2 Percentage of students qualifying in state/national/ international level examinations during the last five years

Year	Registration number/roll number for the exam	Names of students qualified	Name of the qualifying exam
2022-23	9935410226897780	CHILAKALAPUDI SRI HARSHA DEEP	TOEFL
	11421	PEESAPATI APARNA	IELTS

Name: CHILAKALAPUDI, SRI HARSHA DEEP

Last (Family/Sumame) Name, First (Given) Name Middle Name

Email: sriharsha026@gmail.com

Gender: Male

Date of Birth: April 18, 1997

Appointment Number: 9935 4102 2689 7785

Test Date: October 05, 2022



CHILAKALAPUDI, SRI HARSHA DEEP
1-172/1, Rajarajeswari Naga, Road 5
Tangellamudi, Eluru, West Godavari
Eluru, Andhra Pradesh 534005
India

Inst. Code Dept. Code

Country of Birth: India

Native Language: Telugu

Test Center: STNRPIND - Home Edition

Test Center Country: India

Security Identification

ID Type: PASSPORT

ID No.: xxxxxxxxxxxxxxxxxxxxx4553

Issuing Country: India

THIS IS A PDF SCORE REPORT, DOWNLOADED AND PRINTED BY THE TEST TAKER.

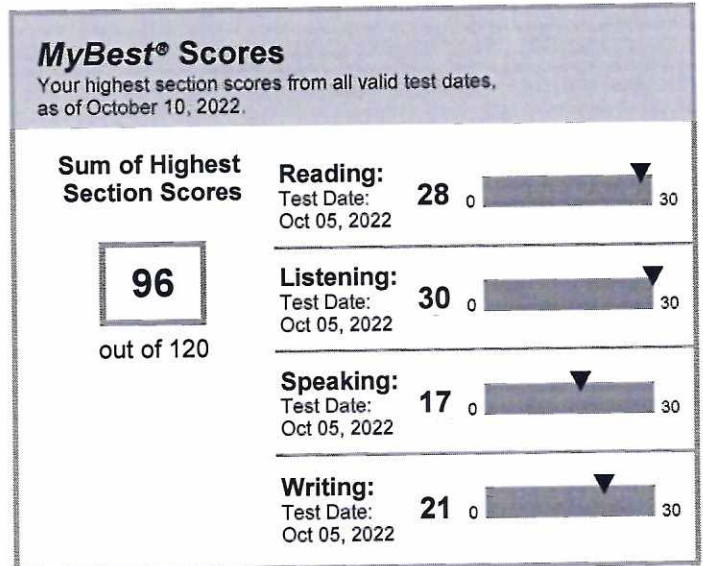
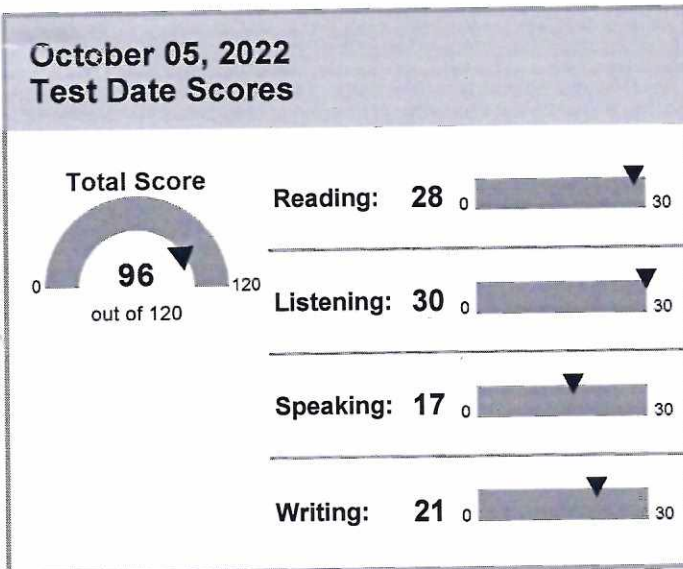

A total score is not reported when one or more sections have not been administered. Expired scores are not included in MyBest® calculations.

THIS IS A PDF SCORE REPORT, DOWNLOADED AND PRINTED BY THE TEST TAKER.

CHILAKALAPUDI, SRI HARSHA DEEP

Date of Birth: April 18, 1997

Appointment Number: 9935 4102 2689 7785

Test Date: October 05, 2022

SCORE RANGES

Total Score	0–120
Reading	0–30
Advanced	24–30
High - Intermediate	18–23
Low - Intermediate	4–17
Below Low - Intermediate	0–3
Listening	0–30
Advanced	22–30
High - Intermediate	17–21
Low - Intermediate	9–16
Below Low - Intermediate	0–8
Speaking	0–30
Advanced	25–30
High - Intermediate	20–24
Low - Intermediate	16–19
Basic	10–15
Below Basic	0–9
Writing	0–30
Advanced	24–30
High - Intermediate	17–23
Low - Intermediate	13–16
Basic	7–12
Below Basic	0–6

INSTITUTION CODES

The Institutions and Department code numbers shown on the front page are the ones you selected before you took the test.

Dept.	Where the Report Was Sent
00	Admissions office for undergraduate study
01, 04-41, 43-98	Admissions office for graduate study in a field other than management (business) or law according to the codes selected when you registered
02	Admissions office of a graduate school of management (business)
03	Admissions office of a graduate school of law
42	Admissions office of a school of medicine or nursing or licensing agency
99	Institution or agency that is not a college or university

For additional information about TOEFL iBT scores, score ranges, and how to improve your skills, visit www.ets.org/toefl/ibt/scores.

IMPORTANT NOTE TO SCORE USERS: This is a PDF score report, downloaded and printed by the test taker. Therefore, ETS cannot guarantee that it has not been altered. To verify the scores on this report, please contact the TOEFL Score Verification Service at +1-800-257-9547 or +1-609-771-7100. Scores more than two years old cannot be reported or validated.

IELTS™

Test Report Form

ACADEMIC

NOTE Admission to undergraduate and post graduate courses should be based on the ACADEMIC Reading and Writing Modules.
GENERAL TRAINING Reading and Writing Modules are **not** designed to test the full range of language skills required for academic purposes.
It is recommended that the candidate's language ability as indicated in this Test Report Form be re-assessed **after two years** from the date of the test.

Centre Number Date Candidate Number

Candidate Details

Family Name
First Name
Candidate ID



Date of Birth Sex (M/F) Scheme Code
Country or Region of Origin
Country of Nationality
First Language

Test Results

Listening Reading Writing Speaking Overall Band Score CEFR Level

Administrator Comments

Centre stamp



Validation stamp



Administrator's Signature

Date

Test Report Form Number



Welcome, Future Lancers!

Discover where
you are meant to be

Laurier Hall \$4,729-\$7,989

- Single rooms for Beyond First-Year students with double beds
- Double rooms for first-year students, coming directly from high school with twin beds
- Common all-gender bathrooms
- Home to the International Student Centre

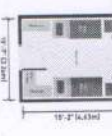

Alumni Hall \$8,997

- Two-bedroom suites
- Full beds
- Semi-private bathroom
- Kitchenette
- Student lounges
- Beyond & First-Year students (coming directly from high school)
- The Corner convenience store

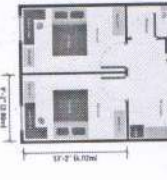

Cartier Hall \$8,398

- Double rooms
- Twin beds
- Semi-private bathroom
- First-Year students (coming directly from high school)

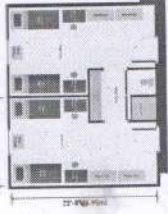

Love Where You Live:

- Meet & live with people from all over the world, we have students from over 41 countries living in residence.
- Get involved with our Residents' Council or advisory boards and you have a say in what happens in residence — for both the fun stuff, like events, and our community standards.
- This may be the only time in your life where you get to live

with hundreds of other people your age and experience the same fun and excitement of living on your own.

• Alumni Hall is the closest residence to the Todd Lancer Centre while Laurier & Cartier are closest to the Student Centre and main areas, but both are within a 10 minute walk to almost anywhere on campus!



Experience life in Residence!

Building / Room Amenities	Alumni	Cartier	Laurier
Secure Entrance	✓	✓	✓
Air Conditioning	✓	✓	✓
Bike/Skate Equipment Room	✓	✓	✓
Bulletin Board in Room	—	✓	✓
Elevators	✓	✓	✓
Fridge (in room or within suite)	✓	✓	✓
Furniture	✓	✓	✓
Kitchen (Common)	✓	✓	✓
Laundry Room	✓	✓	✓
Lounge / Study Rooms	✓	✓	✓
R.A. (Resident Assistant)	✓	✓	✓

* Standard Twin or Full bed depending on room ✓ Included — Not included

Information on these pages are subject to change. For the latest updates, check our our website: uwindsor.ca/residence. This pamphlet was updated March 22, 2023.

Benefits of living in Residence

- ✓ LIVE CLOSE: In the heart of campus
- ✓ LIVE COMMUNITY: Lifetime friendships
- ✓ LIVE CONVENIENCE: More time for campus life
- ✓ LIVE VALUE AFFORDABLE: All-in cost offers



University
of Windsor

Information on these pages are subject to change. For the latest updates, check our our website: uwindsor.ca/residence. This pamphlet was updated March 22, 2023.



University
of Windsor



International Cohort Based Masters Admissions

Office of the Registrar

apply@uwindsor.ca

Congratulations on your admission to the University of Windsor's Professional Program!

The next step is to confirm your offer of admission. Please login to the University's electronic Graduate Application System (eGAS) at www.uwindsor.ca/its/eiss/egas. Once you have printed your offer of admission letter, you can prepare to apply for your visa, bank loan, search for living accommodations and begin making travel preparations.

Program Terms and Conditions

- To secure your place in the program, you must accept the offer of admission through your eGAS account. The offer will expire 21 days from the date on the offer of admission letter. You must also submit a deposit of **\$4000.00 CAD**. The deposit is due 21 days from the date issued on the offer of admission. If you do not provide a deposit by the due date you will not be guaranteed a seat in the class. Payment should be made via www.uwindsor.ca/finance/student-accounts. Payment will be applied to your first term program fees and is refundable only with adequate proof of a refused Student Visa. The VISA refusal letter for the term in which your offer is valid will need to be provided to the Cashier's Office to receive a refund. See the University of Windsor website for the refund policy.
- By accepting this offer of admission, you are also agreeing to register for the University Health Insurance Plan.
- All conditions on your offer letter associated with this offer must be satisfied before the due date indicated.
- This letter of offer is non-transferable. Payment of program fees and/or remittance of program deposit cannot be applied to any other program offered by the University of Windsor.

Condition(s) of Admission

- Degree Confirmation: Please forward an official copy of your degree confirmation/proof of completion of all post-secondary education to the Office of Graduate Admissions (address above) by the listed due date. The Degree Confirmation must be received in the original sealed envelope from the granting institution to be considered official. An attested copy of the original certificate would be accepted if received in the original sealed envelope from the granting institution.



Come back!

After first year, you're welcome to come back to the UWindsor Residence!
 You are welcome to live in residence for the duration of your time on campus. For more information, please visit uwindsor.ca/residence

Get in contact!
 Room 49, Vanier Hall,
 519.253.3000, ext. 3279
uwindsor.ca/residence
reservic@uwindsor.ca
[facebook.com/uwindsorres](https://www.facebook.com/uwindsorres)
[instagram.com/uwindsorres](https://www.instagram.com/uwindsorres)

Welcome to Residence

Campus Living @ UWindsor

UWindsor Residence is more than a place to live!

- Wi-Fi** Included
- Class Community**
- Support Services**
- Furniture Included**
- Resident Assistant**
- 519-253-3000 / 3279 ext. 3279**
- SAH & SACN**

Immerse yourself in university life by living on campus. UWindsor residence invites you to be part of a dynamic community and offers a memorable university experience.

Close to classes, on-campus events and additional facilities, residence life supports your personal growth, both academically and socially.

Participate in exclusive events, take a stroll along the waterfront or enjoy a diverse selection of food with your meal plan – all at your own convenience.

Beyond your stay as a resident, work as a desk services assistant or join a Residence Committee to learn outside the classroom and make lifelong connections.

Staff are on-call 24/7 and resident assistants (RA's) dedicate their time to enhancing your experience and supporting your transition to university.

Living Learning Communities
 Live with students who share your academic program or interest. This allows you to connect with your classmates, join them for studying, work on group assignments, or attend social events. Our current offerings include Black Leadership and Excellence and Nursing Communities.

Choice of Roommate
 Students will be able to select their room and roommate through the application process.

Residence Guarantee
 Accommodations are guaranteed for First-Year students (enrolling directly from high school) who complete their residence application by the guarantee date (see website). After that date, you can still apply and room assignments are based on availability.

Special Considerations
 A select number of rooms are available to students who require special accommodations. We make every effort to place students in rooms that best meet their needs. For more information, please visit uwindsor.ca/residence

Meal Plans
 No need to prepare meals or go grocery shopping. For Fall and Winter, residence students are required to choose a meal plan from a variety of options. You may use the meal plan to pay for food at all outlets on-campus as well as several nearby restaurants. For more information, please visit uwindsor.ca/food.

Bookstore Plan
 For greater convenience, you can add a Bookstore Plan to your Student ID Card. The Bookstore Plan is an optional add-on to your Residence fees. For more information, please visit uwindsor.ca/residence and select Services.

All-Gender
 There are all-gender rooms and washrooms available in all of our residence buildings.





**University
of Windsor**



ENGLISH LANGUAGE IMPROVEMENT PROGRAM

The English Language Improvement Program (ELIP) is UWindsor's pathway to meeting language requirements for entry to your academic program.

- A valid English language assessment score determines which ELIP level to take.
- Successful completion of ELIP 3 qualifies for entry to academic study.
- Each ELIP term is 12 weeks.

If you have an overall IELTS and writing band score of:	~ 5.0	5.0	5.5	6.0 +	Begin your academic program
You will begin in level:	Pre-Academic English	ELIP 1	ELIP 2	ELIP 3	
# of ELIP terms you will need to complete before academic start:	Five/Four	Three	Two	One	

If you do not have an English language assessment score, we can conduct a placement test when you arrive.



LEARN MORE & REGISTER
www.uwindsor.ca/elip

CONTACT US:

✉ applyesl@uwindsor.ca

☎ +519.253.3000 x3425 or x3405

Intercession 2023 - Winter 2024 Course Based Graduate Degrees Fee Schedule

This document is provided for planning purposes only. The exact fees for each term after you register will be posted to your financial account in UWinsite Student on December 1 for the Winter semester, May 1 for the Intercession/Summer semester and August 1 for the Fall semester.
[Click here to link to our Tuition Fee Estimator.](#)



University
of Windsor

Student Accounts Office
Chrysler Hall North, 1st Floor
401 Sunset Avenue, Windsor
Ontario, Canada N9B3T4
T: 519-253-3000 Ex: 3307
cashiers@uwindsor.ca

Graduate Program Tuition	Per Term Or Per Course	Total Tuition Payable
Master of Actuarial Science (MAS) (ACSM)	\$8,925.00	\$35,700.00
Tuition cost	\$1,000.00	\$4,000.00
Estimated Fees	\$9,925.00	\$39,700.00
Total estimated tuition and fees for 4 terms, 16 months		
Masters of Applied Computing (MAC) (CAPM)	\$9,500.00	\$38,000.00
Tuition cost	\$1,000.00	\$4,000.00
Estimated Fees	\$125.00	\$500.00
* Lab Fee	\$10,625.00	\$42,500.00
Total estimated tuition and fees for 4 terms, 16 months	+ \$570.00	+ \$2,280.00
*Co-operative education fees (if admitted)		
Masters of Applied Economics and Policy (MAEP) (ECOMIAEP)	\$8,662.50	\$34,650.00
Tuition cost	\$1,000.00	\$4,000.00
Estimated Fees	\$9,662.50	\$38,650.00
Total estimated tuition and fees for 4 terms, 16 months		
Master of Engineering (All disciplines)*	\$10,375.00	\$41,500.00
Tuition cost	\$1,000.00	\$4,000.00
Estimated Fees	\$11,375.00	\$45,500.00
Total estimated tuition and fees for 4 terms, 16 months	+ \$570.00	+ \$2,260.00
*Co-operative education fees (if admitted)		
Master of Management (MoM) (BUSMIF)(BUSMLS)(BUSMHHM)	\$10,750.00	\$43,000.00
Tuition cost	\$1,000.00	\$4,000.00
Estimated Fees	\$11,750.00	\$47,000.00
Total estimated tuition and fees for 4 terms, 16 months	+ \$375.00	+ \$1,500.00
*Data Analytics Stream -Lab Fee		
Master of Medical Biotechnology (MMB) (CHEMMB)	\$9,375.00	\$37,500.00
Tuition cost	\$1,000.00	\$4,000.00
Estimated Fees	\$250.00	\$1,000.00
* Lab Fee	\$10,625.00	\$42,500.00
Total estimated tuition and fees for 4 terms, 16 months		
Master of Materials Chemistry and Engineering (MMCE) (MMCCEN)	\$8,125.00	\$32,500.00
Tuition cost	\$1,000.00	\$4,000.00
Estimated Fees	\$250.00	\$1,000.00
* Lab Fee	\$9,375.00	\$37,500.00
Total estimated tuition and fees for 4 terms, 16 months		

Notes: Tuition Fees are based on the current year.
All fees are subject to change upon approval of the Board of Governors
Fees are mandatory and will vary term to term

Deposit Information

Deposits:

For programs that require submission of a \$4,000.00 deposit, it is required within 21 days of your date of admission to secure your place in your program. The deposit is non-refundable and applied to your program fees. If your Student Visa is denied, applicants are required email CASHIERS@UWINDSOR.CA of the visa status prior to program start date to ensure enrolment is canceled or deferred. Students must provide timely and adequate proof of denied student visa, not older than 6 months, to be considered for a deposit refund to the originating payment provider. Payment receipts are automatically generated to the student's name, sent by email to the registered email address, once a payment is received and reflected on the student account.

Learn More about fee payment options at www.uwindsor.ca/finance/student-accounts

living expenses. The Offer of Admission letter can be used to apply for a visa/study permit and a bank loan. This page also lists the semester start dates.

Additional Information and Helpful Links

- The International Student Centre provides many great benefits to students through their Soft-landing program, Multi-faith Space, VISA and work permit assistance and social events. Please visit their website for more information at www.uwindsor.ca/isc.
- Residence Services offer many different housing and meal plan options. You need to apply in advance, so you are encouraged to visit their website early www.uwindsor.ca/residence.
- The University of Windsor's Student Alliance (UWSA) maintains links to information about off-campus housing. You can visit their website at www.uwsa.ca.
- Campus Recreation facilities as well as varsity and intramural sports. For more information, please visit their website at www.uwindsor.ca/athletics.

For further information please email your respective department:

- Engineering: mengprog@uwindsor.ca
- Automotive: auto@uwindsor.ca
- Management: management@uwindsor.ca
- Applied Computing: macprogram@uwindsor.ca
- Medical Biotechnology: trantum@uwindsor.ca
- Actuarial Science: mthsta1@uwindsor.ca
- Applied Economics and Policy: nurlan@uwindsor.ca
- Master of Materials Chemistry and Engineering: zareen.amtul@uwindsor.ca

- Transcripts: Please forward an official copy of all post-secondary education transcripts to the Office of Graduate Admissions by the indicated due date. Transcripts must be received by Graduate Admissions in the original sealed envelope from the granting institution(s) to be considered official. Documents need to be submitted in official capacity.
 - You can have your University send the official documents to the University of Windsor directly at transcripts@uwindsor.ca.
 - Alternatively, you can mail the documents at:

University of Windsor
Office of the Registrar - Graduate Studies Division
401 Sunset Ave.
Windsor, Ontario, N9B 3P4 Canada

If you have English Language Conditions on your offer:

- English Proficiency Test Score: Please request the testing centre to send your results directly to the University of Windsor. Our institution code is 0904. Please note that the language requirements of the program must be met prior to attendance in any courses at the University of Windsor.
- English Language Improvement Program (ELIP): If you do not meet the language requirements of your academic program, you can register for language training at the Centre for English-Language Development at the University of Windsor. You will not be able to begin any coursework until all language requirements of the program are met.

You must register for ELIP at uwindsor.ca/englishlanguagedevelopment.ca.
Direct inquiries can be directed to applyesl@uwindsor.ca.

- ELIP fees can be taken from this deposit; however, students will be required to replenish the deposit to \$4000.00 CAD before registering for courses.
- Study Permit: You must submit your study permit to our International Student Centre, located in Laurier Hall on the University of Windsor Campus. You can do this when you arrive in Windsor.

Tuition Information and Program Length

- There is a section at the end of your offer of admission letter with "additional information". This section provides a link to a page that lists your tuition information and program length required for your visa application as well as an approximation of

Other Requirements

Scholarships, graduate/teaching assistantships or research assistantships are not available for students accepted to this program.

Must present your valid student study permit to the International Student Centre (isc@uwindsor.ca) by the last day to add courses within the first term of registration.

As a reminder: to reserve your place in this program you need to accept this offer of admission by September 05, 2023.

International students please note: This is your official, final letter of acceptance. Please present this letter to apply for your study permit. This letter has been issued electronically.

Additional Information:

Please ensure that you have sufficient funds to meet all of your needs before accepting this offer.

Program fees and Term Start Dates: This information can be found at <https://www.uwindsor.ca/gradprogfee> while a tuition fee estimator is also provided at <https://www.uwindsor.ca/finance/fee-estimator>.

Living Expenses: A reasonable minimum estimate for a graduate student with no dependents is \$10,000 per year (\$14,000 per year if have one dependent). These expenses are in addition to tuition (does not include compulsory incidentals), books, and health insurance.

Housing and Accommodation: The University of Windsor offers on-campus housing and meal plans; additional information is provided at <https://www.uwindsor.ca/residence>.

Do you have a question: Please visit <https://ask.uwindsor.ca>.

Let me be the first to welcome you to the Lancer family. You are about to embark on an important journey. We could not be happier that you have chosen the University of Windsor as your partner in learning.

All the best,

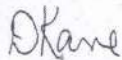

Dr. Debbie Kane
Acting Dean, Faculty of Graduate Studies
University of Windsor



Faculty of Graduate Studies & Office of Quality Assurance
401 Sunset Avenue
Windsor, Ontario, Canada N9B 3P4
www.uwindsor.ca/graduate

August 15, 2023

Aparna Peesapati
2-60-57/1, Near Krishna Temple Saikrishna Nagar,
Rajahmundry Urban, AP, 533101
India

UWin ID: peesapaa
Student Number: 110156981
PIN: 534188
Offer Expiry Date: September 05, 2023
DLI: O19358946722

Dear Aparna,

Congratulations! We are pleased to offer you admission to the University of Windsor in the following graduate program:

Academic Program/Plan:	Master of Applied Computing
Program/Plan Start Date:	InterSummer 2024
Duration of Program:	4 Terms equivalent to 2 years
Enrollment Status:	Full Time

In accepting this offer, you will be joining a welcoming community of exceptional students, award-winning faculty and researchers and dedicated staff who are working together to explore and address the problems of the world. Our rich academic programs and exciting opportunities for experiential learning produce graduates who enjoy challenging and rewarding careers.

HOW TO RESPOND TO YOUR OFFER

You must accept (or decline) your offer of admission through eGAS:

- Log into [eGAS](#)
- Click the **Offer Acceptance** tab
- From the **Details** drop-down menu, select an option (accept, decline or defer if applicable for your program)
- Click **Save**

Conditions and Provisions:

Transcript(s):

Confirmation of degree completion must be received by the Office of the Registrar-Graduate Division by the stipulated deadline. Documents must be received directly from your institution or delivered in a sealed envelope issued by your institution.

Date Due: August 1, 2024

Final transcripts indicating all courses & grades must be submitted prior to the end of the first academic semester. Documents must be received directly from your institution or delivered in a sealed envelope issued from your institution to the Office of the Registrar-Graduate Division.